



**CRES Commercial
Real Estate SFL**

KOBOSKO'S CROSSING

BEST RETAIL DEAL IN WELLINGTON

FEATURED FOR LEASE RETAIL CENTER

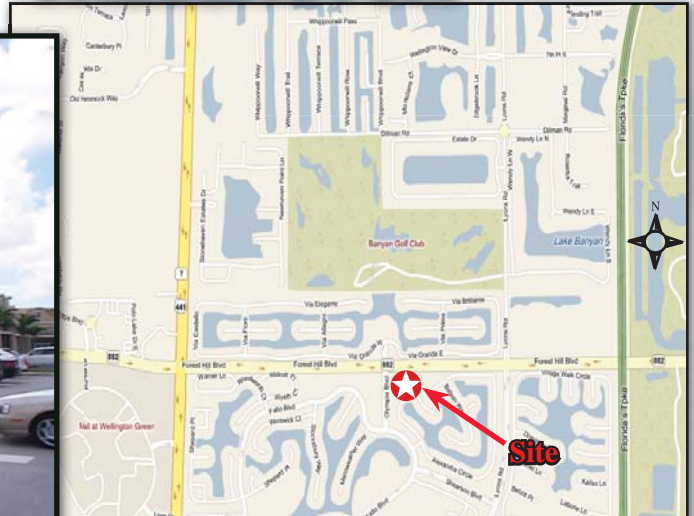

**9100-9316 Forest Hill Boulevard,
Wellington, FL 33411**

- 38,100 Rentable SF in Four Buildings
- Bay sizes from 975 SF
- Attractively Designed Two Year Old Center
- Fronting Olympia, an Upscale Residential Community
- On the South Side of Forest Hill Boulevard, ½ Mile east of US 441, Wellington, FL
- Over 44,000 Average Daily Traffic Count
- Call For Availabilities



We Know.

**Prudential CRES Commercial
Real Estate SFL
5301 N Federal Hwy, Ste 150
Boca Raton, FL 33487
tel. 561-995-8887
fax. 561-995-7151
www.prudentialcressfl.com**

Elias Porras, Jr.

Ext:288 eporras@prudentialcressfl.com

Offices throughout South Florida

This information is believed to be accurate. We are not responsible for misstatements of facts, errors or omissions, prior sale, change of price or withdrawal from the market without notice. © 2006, Prudential Financial. Prudential Real Estate brokerage services are offered through the independently owned and operated network of broker member franchisees of The Prudential Real Estate Affiliates, Inc., a Prudential Financial company. Prudential is a registered trademark of The Prudential Insurance Company of America. The information above has been obtained from sources believed reliable. While we do not doubt its accuracy we have not verified it and make no guarantee, warranty or representation about it. It is your responsibility to independently confirm its accuracy and completeness. Any projections, opinions, assumptions, or estimates used are for example only and do not represent the current or future performance of the property. The value of this transaction to you depends on tax and other factors which should be evaluated by your tax, financial and legal advisors. You and your advisors should conduct a careful, independent investigation of the property to determine to your satisfaction the suitability of the property for your needs.

© 2008. An independently owned and operated member of Prudential Real Estate Affiliates, Inc.
Prudential is a registered service mark of The Prudential Insurance Company of America. Equal Housing Opportunity.



Prudential

**CRES Commercial
Real Estate SFL**

SITE PLAN

